

For legend details, please refer to the Coversheet attachment provided as part of this BYDA response.

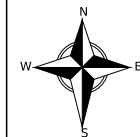

Scale: 1:2101

Issue Date: 27/08/2024
 BYDA Seq No: 243875493
 BYDA Job No: 37459211
 Overview Page:

WARNING: This is a representation of Jemena Gas Networks underground assets only and may not indicate all assets in the area. It must not be used for the purpose of exact asset location in order to undertake any type of excavation. Please read all conditions and information on the attached information sheet. This extract is subject to those conditions. The information contained on this plan is only valid for 28 days from the date of issue.

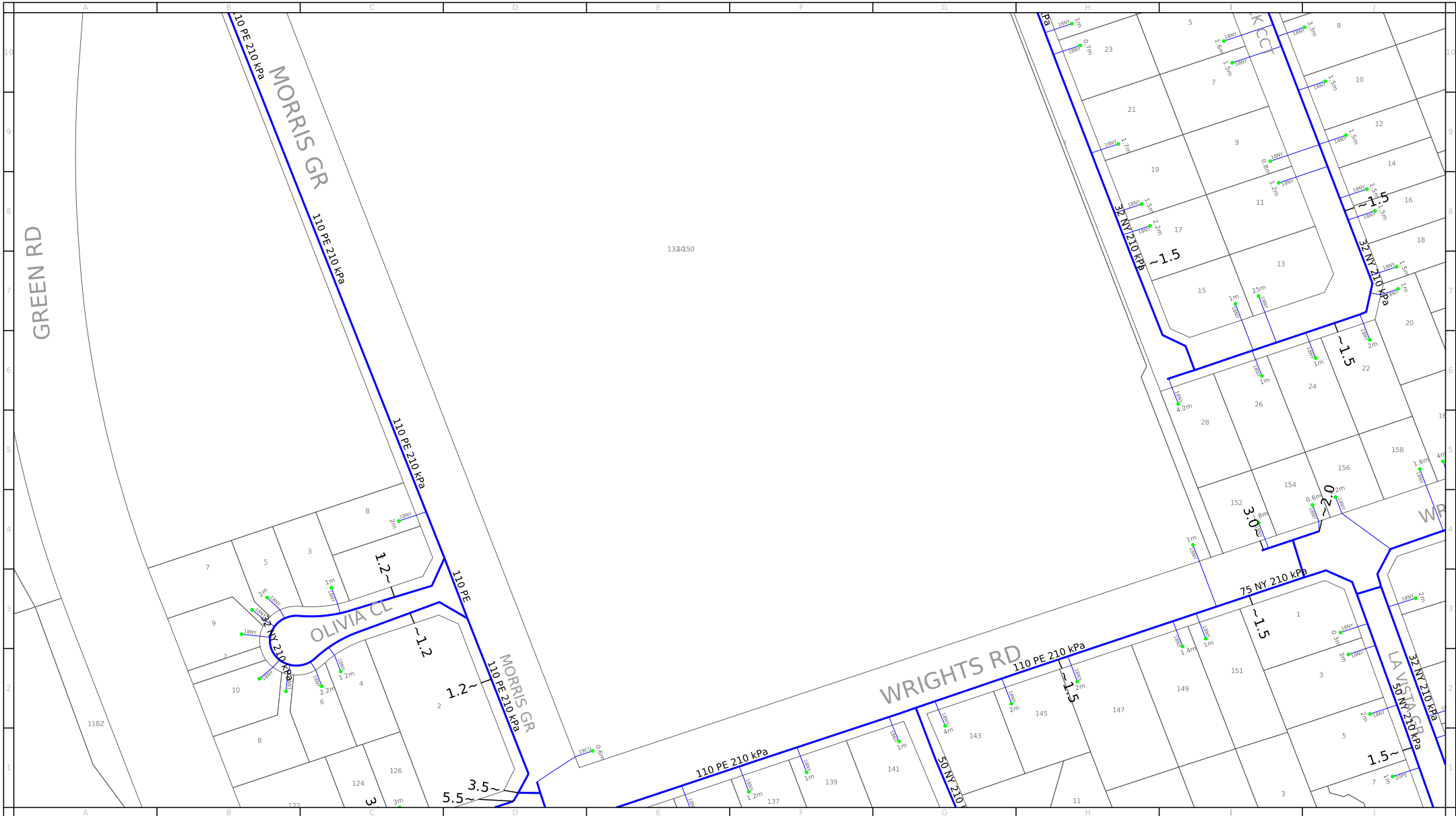

For legend details, please refer to the Coversheet attachment provided as part of this BYDA response.

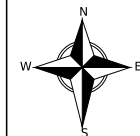

Scale: 1:2000

Issue Date: 27/08/2024
 BYDA Seq No: 243875493
 BYDA Job No: 37459211

0m 10m 20m 30m 40m 50m 60m 70m 80m



WARNING: This is a representation of Jemena Gas Networks underground assets only and may not indicate all assets in the area. It must not be used for the purpose of exact asset location in order to undertake any type of excavation. This plan is diagrammatic only, and distances scaled from this plan may not be accurate. Please read all conditions and information on the attached information sheet. This extract is subject to those conditions. The information contained on this plan is only valid for 28 days from the date of issue.

ASSETS AFFECTED

This information is only valid for 28 days from the date of issue

Please note that there are **Gas Mains or Services** in the vicinity of your intended work, as generally illustrated on the attached map. There may also be other mains or services at the location. For an explanation of the map, please see the legend attachment and read the important information below.

Please note that you have duty of care to ensure that Jemena's assets are not compromised or damaged during any digging, future development or construction work.

Excavation Guidelines:

It is essential that the location of gas pipe/s are confirmed by carefully pot-holing by hand excavation prior to proceeding with mechanical excavation in the vicinity of gas pipes. If you cannot locate the pipe, contact the local depot.

Important Information:

1. The enclosed plans have been prepared solely for the use of Jemena Gas Networks (NSW) Ltd and Jemena Asset Management Pty Ltd (together "Jemena") and show the position of Jemena's underground gas mains and installations in public gazetted roads. If the enclosed plans show gas assets located on private property or other third party property, these are approximate locations.
2. There may be underground assets owned by other utilities in the vicinity of your work and it is your responsibility to identify and locate such assets.
3. The plans may show the position of underground mains and installations relative to fences, buildings and other structures, as they existed at the time the assets were installed and may not have been updated to take account of any subsequent change in the location or style of those features. Depth of underground assets may also vary as a result of changes to road, footpath or surface levels subsequent to installation.
4. While Jemena takes all reasonable care to ensure the accuracy and completeness of the information provided, it makes no warranty as to the accuracy or completeness of the enclosed plans and does not assume any duty of care to you nor any responsibility for the accuracy, adequacy, suitability or completeness of the plans or for any error or omission. It is intended to be indicative only and must not be solely relied upon when undertaking underground works.
5. Except to the extent that liability may not be capable of being lawfully excluded, Jemena, its employees, agents, officers and contractors will not be liable to any person for loss or damage (including indirect and consequential loss or damage) which may be suffered or incurred in connection with the provision of this information.
6. Persons excavating or carrying out other earthworks will be held responsible for any damage caused to Jemena's underground mains, service lines and equipment. In accordance with the *Work Near Underground Assets – Guide* published in 2007 by Work Cover Authority*, Jemena recommends that you carry out potholing by hand to accurately confirm the location of gas mains and installation prior to commencing excavations.

Network Mains

- Proposed New Main (coloured as per kPa)
- Proposed Isolate (coloured as per kPa)
- Unknown kPa
- 2kPa Low Pressure gas main
- 7kPa Low Pressure gas main
- 30kPa Medium pressure gas main
- 100kPa Medium Pressure gas main
- 210kPa Medium Pressure gas main
- 300kPa Medium Pressure gas main
- 400kPa Medium Pressure gas main
- 1050kPa High Pressure gas main
- 3500kPa High Pressure gas main
- 7000kPa High Pressure gas main
- >7000kPa Transmission pipeline
- Isolated Service - Former Med/High Pressure
- Isolated Steel Main - **Treat as High Pressure**
- Conduit or Casing
100 PVC Size & Material (see conduit material codes)
- Critical Main - **Treat as High Pressure**
(Main coloured as per kPa)
- Exposed Main section
EXPOSED
- Shallow Main section: see Protection Code below, no code assume no protection
SHALLOW-SP

SP	Steel Plate	CE	Concrete Encased
PP	PE Plate	UNK	Unknown Type
CS	Concrete Slab		
- Warning** - Blue Jacket Coated gas main
(Main coloured and styled as per kPa)

Gas Services

- Gas service – coloured by kPa
- Serviced Site indicator

Jemena has created service pipe features programmatically based on known pipe characteristics and cartographic principles. They may provide guidance to identify assets whilst in the field in addition to existing processes.

Network Assets

- Siphon
- Network Valve
- High Pressure Main Line Valve ($\geq 1050\text{kPa}$)
- High Pressure Automatic Line Break Valve ($> 1050\text{kPa}$)
- Boundary Regulator Set ($\leq 1050\text{kPa}$)
- Distribution Regulator Set ($\leq 1050\text{kPa}$)
- High Pressure Regulating Station ($> 1050\text{kPa}$)

Annotations

Pipe and Conduit Material Codes

NY	Nylon	NB	Nominal Bore – Cast Iron
PE	Polyethylene	ST	Steel
P/PL	Plastic (undefined)	C/CO	Copper
PVC	Polyvinyl Chloride		

Pipe code combinations and dimension references

- 6 NB 50MM NY** 50mm Nylon main inserted into 6 inch (Nominal Bore) Cast Iron pipe
- 50MM 32MM NY** 32mm Nylon main inserted into 50mm Steel pipe

~1.5 Distance (in metres) of main from Boundary Line (MBL)

MBK	Distance in Metres Back of Kerb
MKL	Distance in Metres from Kerb Line
MEBL	Distance in Metres from Eastern Boundary Line (North/South/West)
MCL	Distance in Metres from Centre Line of Road
MFL	Distance in Metres from Fence Line

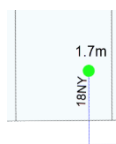

Distance (in metres) of service from side Boundary where the service pipe crosses from the road reserve into the private lot
Service placed towards left or right boundary
Service pipe size & material where known

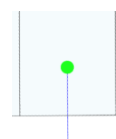

For connected sites with insufficient asset details, service is shown down the centre of the lot with no attributes plotted